

**CAUTION**  
Make sure that anyone working with the Flex TechBridge & Accessories has read and understands these instructions.

**CAUTION**  
Failure to comply with Warnings and Cautions in this document can result in damage to property or serious injury.

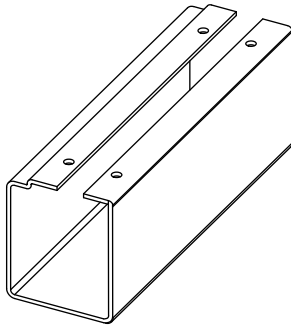

### PARTS LIST

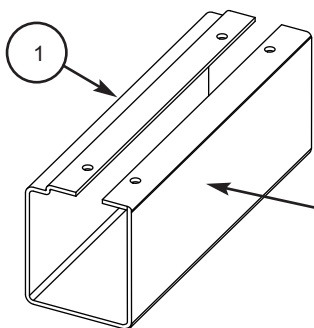

Note: This side towards the user.

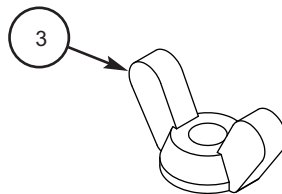
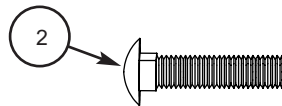

Item	Qty	Description
1	1	Power Strip Shelf
2	4	Carriage Bolt, 3/8-16 x 3/4"

Item	Qty	Description
3	4	Nylon Wing Nut, 3/8-16

## ASSEMBLY

**Note:** If the Power Strip Shelf is being assembled after the Flex TechBridge is already assembled, the Upright Posts will need to be loosened and removed to assemble the Power Strip Shelf. Refer to "Flex TechBridge Assembly".

1. From the top of the Bridge, insert one 3/8-16 Carriage Bolt through each of the two slots as shown.

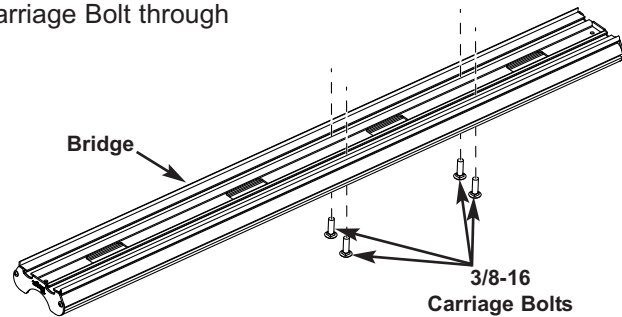

2. Position the Power Strip Shelf, aligning the Carriage Bolts with the four mounting holes in the box.

**Note:** Assemble the Power Strip Shelf with the flat side (without the curved edge) towards the user. See the illustration above.

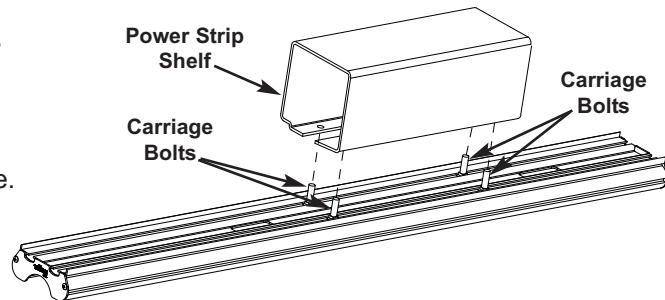

3. Thread four Nylon Wing Nuts onto each of the Carriage Bolts and tighten them when the Power Strip Shelf is in the desired position.

**Note:** Allow enough space on each end of the Flex TechBridge to assemble the Support Legs.

